

IG 34/42 - SB with HE Feedback

Model Numbering

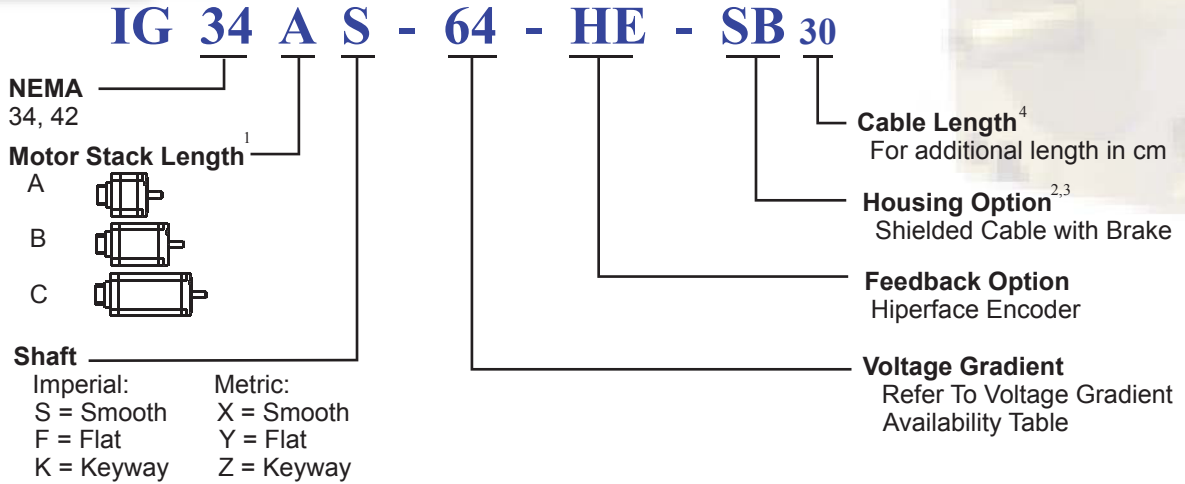

1. Refer to Dimensions for the exact length and shaft options, IG 42 just comes in Stack A and B
2. All the motors are rated IP64 and by adding front shaft seal it's rating becomes IP65
3. Comes with 18 inches (46cm) shielded cable
4. Blank for Standard length (18 inches = 46 cm)

Voltage Gradient

Voltage Constant K_E (V/kRPM)		16	22	32	44	64	88	130	180	260	360
Frame Size	IG 34										
	IG 42										

Performance Curves

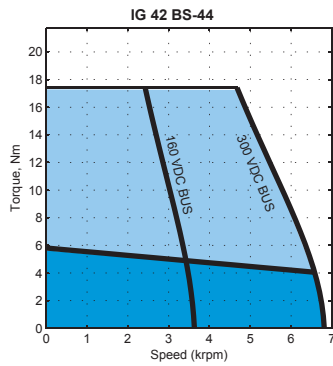
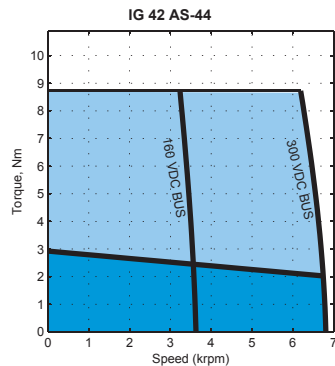
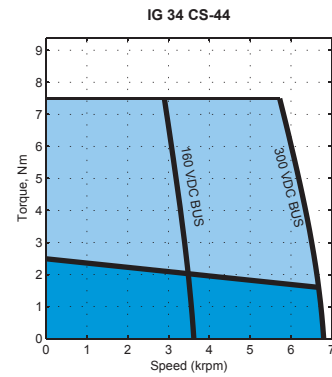
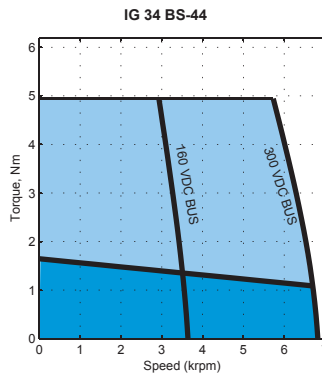
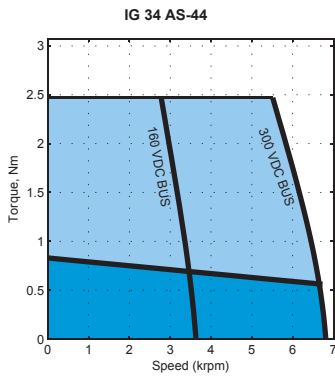

Contact factory for torque-speed curves of other motors

Mar, 20, 06

IG 34/42 with SB Housing and HE Feedback

Motor Drawing

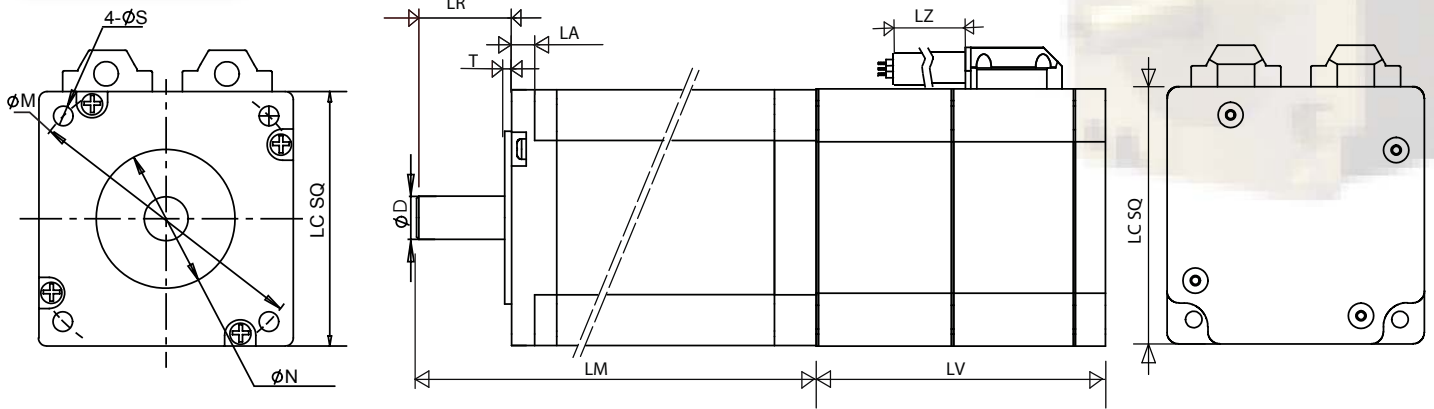

FRONT SHAFT OPTIONS
 (1) SMOOTH SHAFT, AS SHOWN IN THE VIEWS
 (2) KEYWAY SHAFT
 (3) FLAT SHAFT

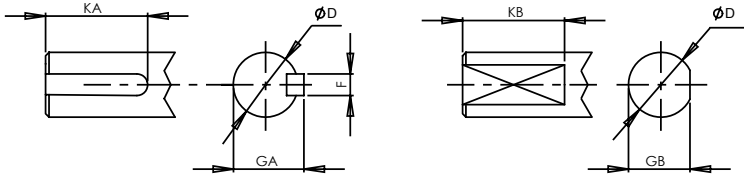

NOTE:

ALL THE MOTORS ARE RATED IP64 AND BY ADDING FRONT SHAFT SEAL, IT'S RATING BECOMES IP65

Units: inches (mm)

IG		LM	LV	LA	T	LR	LC	LZ	N	S	M
34	A	2.795 (71)	3.8 (96.6)	0.33 (8.4)	0.059 (1.5)	1.260 (32)	3.386 (86.0)	18 (457.2)	2.875 ⁰ _{-0.0012} (73.03 ⁰ _{-0.031})	0.217 (5.5)	3.875 (98.43)
	B	3.858 (98)									
	C	4.921 (125)									
42	A	4.449 (113)	3.8 (96.6)	0.49 (12.5)	0.059 (1.5)	2.126 (54)	4.332 (110.0)	18 (457.2)	2.186 ⁰ _{-0.0018} (55.52 ⁰ _{-0.046})	0.335 (8.5)	4.950 (125.73)
	B	6.811 (173)									
	C	-									

IG	Imperial Shaft Option (S/F/K), Units: inches						Metric Shaft Option (X/Y/Z), Units: mm					
	D	F	GA	KA	GB	KB	D	F	GA	KA	GB	KB
34	0.50 ⁰ _{-0.0005}	0.1250 ⁰ _{-0.001}	0.555 ⁰ _{-0.004}	1.0	0.473 ⁰ _{-0.004}	1.0	14 ⁰ _{-0.013}	5 ⁰ _{-0.08}	16.0 ⁰ _{-0.1}	45	13 ⁰ _{-0.1}	45
42	0.75 ⁰ _{-0.0005}	0.1875 ⁰ _{-0.0012}	0.830 ⁰ _{-0.004}	1.5	0.709 ⁰ _{-0.004}	1.5	19 ⁰ _{-0.013}	6 ⁰ _{-0.030}	21.5 ⁰ _{-0.1}	45	18 ⁰ _{-0.10}	45

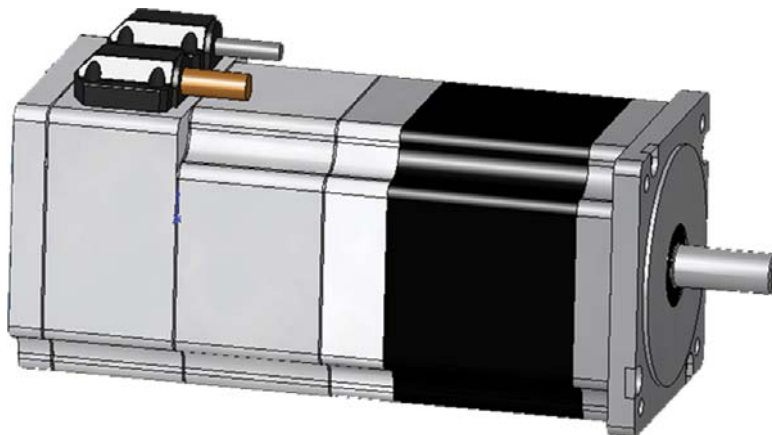

Mar, 21, 06

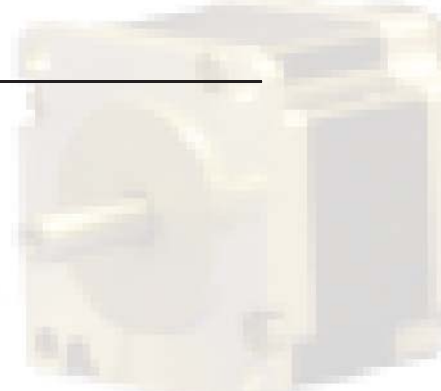

Power Cable Wire Code

Power Cable for Brake Wire Code

Wire Code	Function
WIRE #1	PHASE U
WIRE #2	PHASE V
WIRE #3	PHASE W
WIRE #4	Brake 1
WIRE #5	Brake 2
GRN/YEL	Ground
Shield	Shield

SAB CC600CYT, 7 Pins, AWG16/20
(depending on current), 600V, 105C,
UL, CE, CSA

24vdc Fail-Safe Brake Data

IG	Supply Power (mA)	Holding Torque lb-in (Nm)
34	520	30 (5.64)
42	708	50 (5.64)

Hiperface Encoder

Hiperface Encoder Data SRS 50, SRM 50

Parameter	Values
# of sine/cosine periods per revolution	1,024
Code type for the absolute value	Binary
Total number of steps (single SRS)	32,768
Output frequency for sine/cosine signals	0 .. 200 kHz
Operating speed (SKS)	12,000 min ⁻¹
Working temperature range	+ 5 ... + 115°C
Operating voltage range	7 ... 12 v
Recommended supply voltage	8 v
Max. operating current, no load	80 mA
Interface signals	
Process data channel=SIN, REFSIN, COS, REFCOS	Analogue, differential
Parameter channel = RS 485	Digital

Hiperface Encoder Cable

Wire Code	Function
BRN/BLK	REFSIN
BLK/BRN	REFCOS
BLU/BLK	DATA+
BLK/BLU	DATA-
ORN/BLK	+SIN
BLK/ORN	+COS
WHT/BLK	+7~12VDC
BLK/WHT	GND
RED/WHT	Thermistor 1
WHT/RED	Thermistor 2
Shield	Shield